

RNA Series Solid State Relay (Single phase AC output)

Photos and Features



Features:

- ★ Zero crossing or random conduction switch.
- ★ Load current: 15A-125A@24-660VAC.
- ★ AC Output or DC Output.
- ★ Medium withstand voltage 4000VACrms.
- ★ LED indicator

Model Illustration

RNA-AP25A380

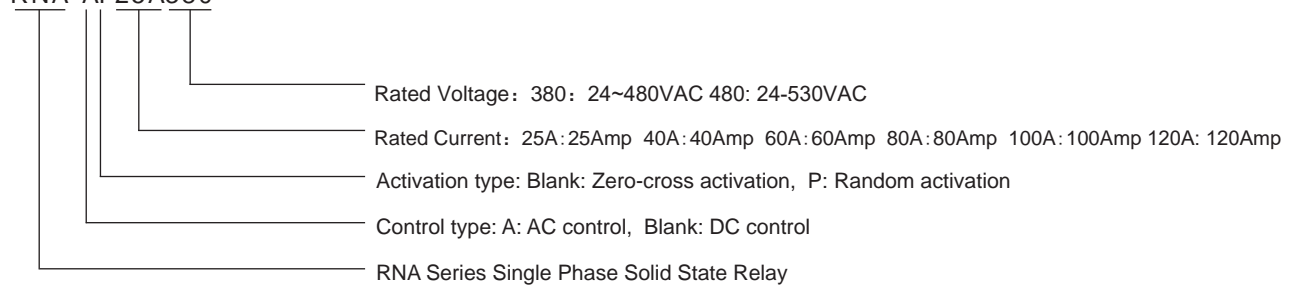

Technical Specifications

Input Parameters (Ta=25°C)	Control Voltage Range	DC Control	3~32VDC	Output Parameters (Ta=25°C)	Output voltage range	380V	24-480VAC
		AC Control	90~280VAC			480V	24-530VAC
	Minimum turn-on voltage	DC Control	3VDC			600V	24-660VAC
		AC Control	90VAC		Max Conducting Time	DC Control (Zero-cross)	1ms
	Minimum turn-off voltage	DC Control	1VDC			DC Control (Radom)	10ms
		AC Control	15VAC			AC Control	40ms
Maximum input current	DC Control	25mA (@32VDC)	Max Closing time	DC Control	10ms		
		AC Control		35mA (@280VAC/50Hz)	AC Control	20ms	
Other Parameters (Ta=25°C)	Medium Withstand voltage [50/60Hz]	Input/Output	4000Vrms	Max Surge Current [@10ms]	15A	150A	
		Input/Output/Bottom	2500Vrms		25A	250A	
	Working Temperature Range	-30°C~+80°C					

Other Parameters (Ta=25°C)	Storage Temperature Range		-30°C~+100°C	Output Parameters (Ta=25°C)	Max Surge Current [@10ms]	40A	400A
	Insulation resistance (@500VDC)	Input/Output	1000MΩ			60A	600A
		Input/Output/Bottom				80A	800A
	Minimum power factor		0.5			100A	1000A
	Minimum load current		100mA			125A	1250A
Weight		75g	Max I ² t value [@10ms]	15A	112A ² s		
Output Parameters (Ta=25°C)	Max Transient Voltage	240V		600Vpk	25A	312A ² s	
		480V		1200Vpk	40A	800A ² s	
		600V		1600Vpk	60A	1800A ² s	
	Max off-state leakage current (under rated voltage)			0.1mA	80A	3200A ² s	
	Max turn-on voltage drop (under rated current)			1.5Vrms	100A	5000A ² s	
	Working frequency range			47Hz~63Hz	125A	7812A ² s	

■ Dimensions (mm)

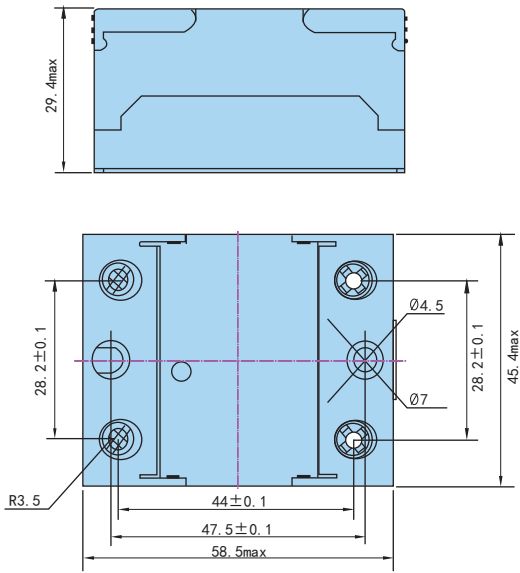

	<p>Use cold rolled copper nose wiring connection</p> <p>Input terminal: W=9.5mm max</p> <p>Output terminal: W=12mm max</p> <p>Wire: Input terminal: Max 3mm²</p> <p>Torque: Output terminal: Max 2x6mm²</p> <p>Torque: Input terminal: (0.58-0.98)N·m</p> <p>Output terminal: (0.98-1.37)N·m</p>
--	--

■ Connection

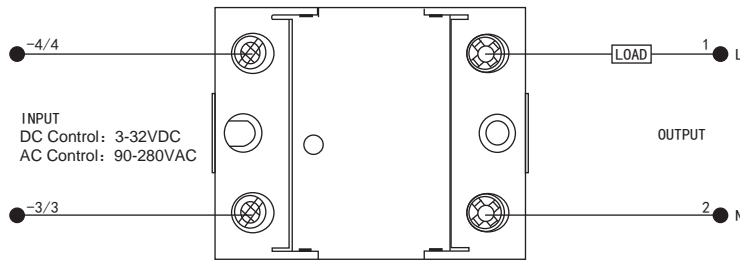

■ Temperature curve

